

HI 6850 SERIES INSTRUMENT

REV.	ECO/DDC	DESCRIPTION	DATE	DRAFT	CHECK	APVD
A	---	RELEASED.	10-12-23	V.J.C.	L.N.	V.J.C.

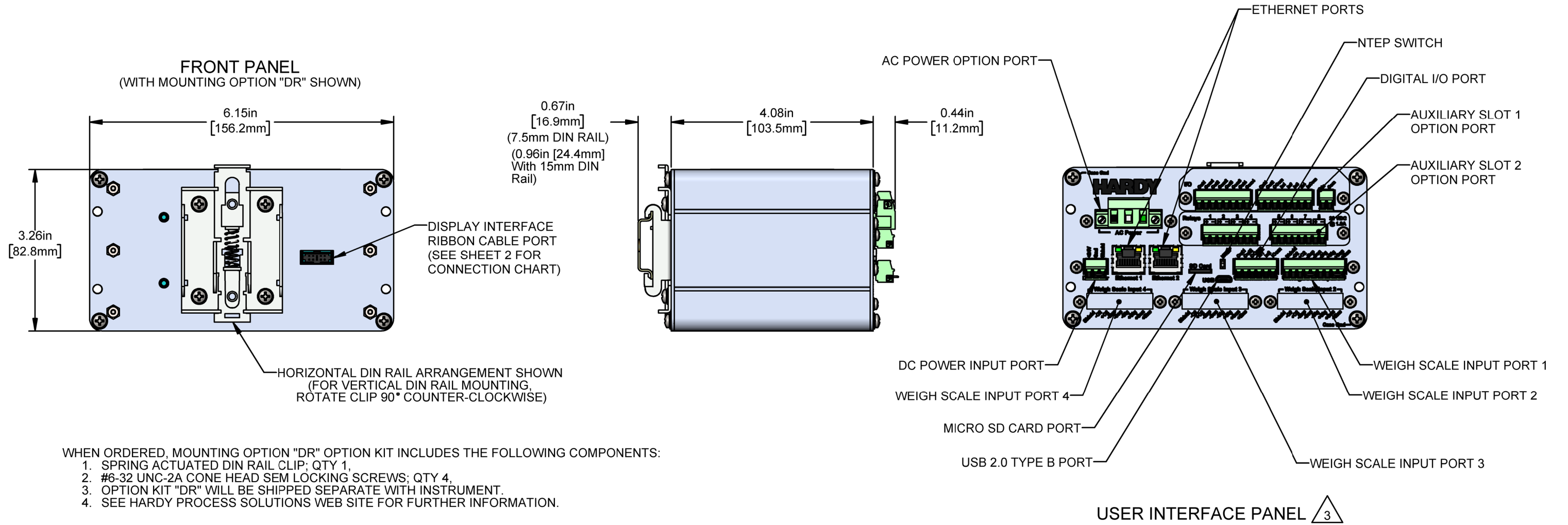

WHEN ORDERED, MOUNTING OPTION "DR" OPTION KIT INCLUDES THE FOLLOWING COMPONENTS:

1. SPRING ACTUATED DIN RAIL CLIP; QTY 1,
2. #6-32 UNC-2A CONE HEAD SEM LOCKING SCREWS; QTY 4,
3. OPTION KIT "DR" WILL BE SHIPPED SEPARATE WITH INSTRUMENT.
4. SEE HARDY PROCESS SOLUTIONS WEB SITE FOR FURTHER INFORMATION.

5. OPTION CONTENT SHOWN WITHIN THIS DOCUMENT MAY NOT NECESSARILY BE AVAILABLE ON EVERY HI 6850 INSTRUMENT APPLICATION SOFTWARE VARIANT. SEE HARDY PROCESS SOLUTIONS WEB SITE FOR INSTRUMENT SPECIFIC APPLICATION SOFTWARE VARIANTS.

4. IF THE HI 6850 INSTRUMENT IS USED IN A MANNER NOT SPECIFIED BY HARDY PROCESS SOLUTIONS, THE PROTECTION PROVIDED BY THE INSTRUMENT MAY BE IMPAIRED.

3 SEE SHEETS 4 THROUGH 6 FOR USER INTERFACE CONNECTIONS.

2. SEE SHEETS 2 AND 3 FOR PANEL MOUNT DISPLAY OPTIONS.

1. SEE HARDY PROCESS SOLUTIONS WEB SITE FOR ADDITIONAL MOUNTING AND WIRING INFORMATION.

NOTES: UNLESS OTHERWISE SPECIFIED

PROPRIETARY NOTICE
ALL DATA AND INFORMATION CONTAINED IN OR DISCLOSED BY THIS DOCUMENT IS CONFIDENTIAL AND PROPRIETARY INFORMATION OF HARDY PROCESS SOLUTIONS AND ALL RIGHTS THEREIN ARE EXPRESSLY RESERVED. BY ACCEPTING THIS MATERIAL THE RECIPIENT AGREES THAT THIS MATERIAL AND THE INFORMATION CONTAINED THEREIN IS HELD IN CONFIDENCE AND IN TRUST AND SHALL NOT BE USED, COPIED, REPRODUCED IN WHOLE OR IN PART, NOR ITS CONTENTS REVEALED IN ANY MANNER TO OTHERS, EXCEPT TO MEET THE SPECIFIC PURPOSE FOR WHICH IT WAS DELIVERED.

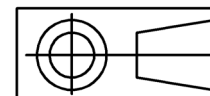

ITEM	QTY	PART NUMBER	DESCRIPTION	COMMENTS														
		0584-0113	INSTALLATION/INTERCONNECTION DIAGRAM, HI 6850 SERIES	SEE NOTES														
PARTS LIST																		
UNLESS OTHERWISE SPECIFIED DIMENSIONS ARE IN INCHES TOLERANCES ARE: FRACTIONS: N/A DECIMALS: .XX = ±.03 .XXX = ±.010 ANGLES ±0°, 30°			<table border="1"> <tr> <th colspan="2">CONTRACT NO.</th> </tr> <tr> <th colspan="2">APPROVALS</th> </tr> <tr> <td>DRAWN V. CHULA</td> <td>DATE 10-12-23</td> </tr> <tr> <td>CHECKED L. NICDAO</td> <td>DATE 10-12-23</td> </tr> <tr> <td>APPROVED V. CHULA</td> <td>DATE 10-12-23</td> </tr> <tr> <td>ISSUED V. CHULA</td> <td>DATE 10-12-23</td> </tr> <tr> <td>PRODUCTION</td> <td>DATE</td> </tr> </table>		CONTRACT NO.		APPROVALS		DRAWN V. CHULA	DATE 10-12-23	CHECKED L. NICDAO	DATE 10-12-23	APPROVED V. CHULA	DATE 10-12-23	ISSUED V. CHULA	DATE 10-12-23	PRODUCTION	DATE
CONTRACT NO.																		
APPROVALS																		
DRAWN V. CHULA	DATE 10-12-23																	
CHECKED L. NICDAO	DATE 10-12-23																	
APPROVED V. CHULA	DATE 10-12-23																	
ISSUED V. CHULA	DATE 10-12-23																	
PRODUCTION	DATE																	
MATERIAL																		
FINISH																		
DO NOT SCALE DRAWING			INSTALLATION/INTERCONNECTION DIAGRAM, HI 6850 SERIES															
SIZE	FSCM	DRAWING NO.	REV.															
D	21316	0584-0113	A															
FILE NAME:0584-0113A1.SLDDRW			SCALE: NONE	SHEET 1 OF 6														

HI 6850 SERIES INSTRUMENT WITH OPTION "PM1" FRONT PANEL DISPLAY

WHEN ORDERED, MOUNTING OPTION "PM1" OPTION KIT INCLUDES THE FOLLOWING COMPONENTS:

1. MODEL HI 6130 - 4.3 INCH TOUCH SCREEN LCD DISPLAY (SEALING GASKET INCLUDED); QTY 1.
2. 4.00 INCH [101.6mm] LONG 10 POSITION DISPLAY INTERFACE RIBBON CABLE; QTY 1.
3. M4 X 0.7, 126mm LONG THREADED RODS, QTY 4.
4. M4 FLAT WASHERS; QTY 4.
5. M4 X 0.7 HEX NUTS; QTY 4.
6. M4 X 0.7 THREADED THUMB NUTS; QTY 4.
7. DISPLAY MOUNTING HOLE DRILL TEMPLATE; QTY 1.
8. OPTION KIT "PM1" WILL BE SHIPPED SEPARATE WITH INSTRUMENT.
9. SEE HARDY PROCESS SOLUTIONS WEB SITE FOR FURTHER INFORMATION.

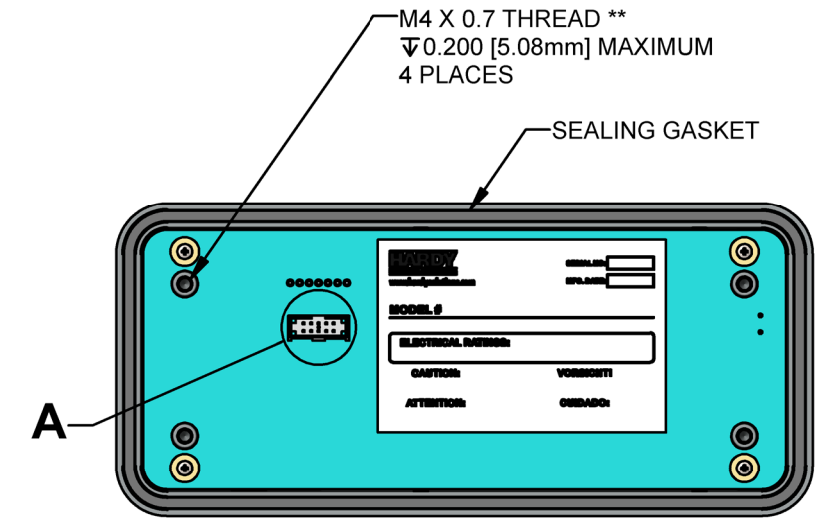
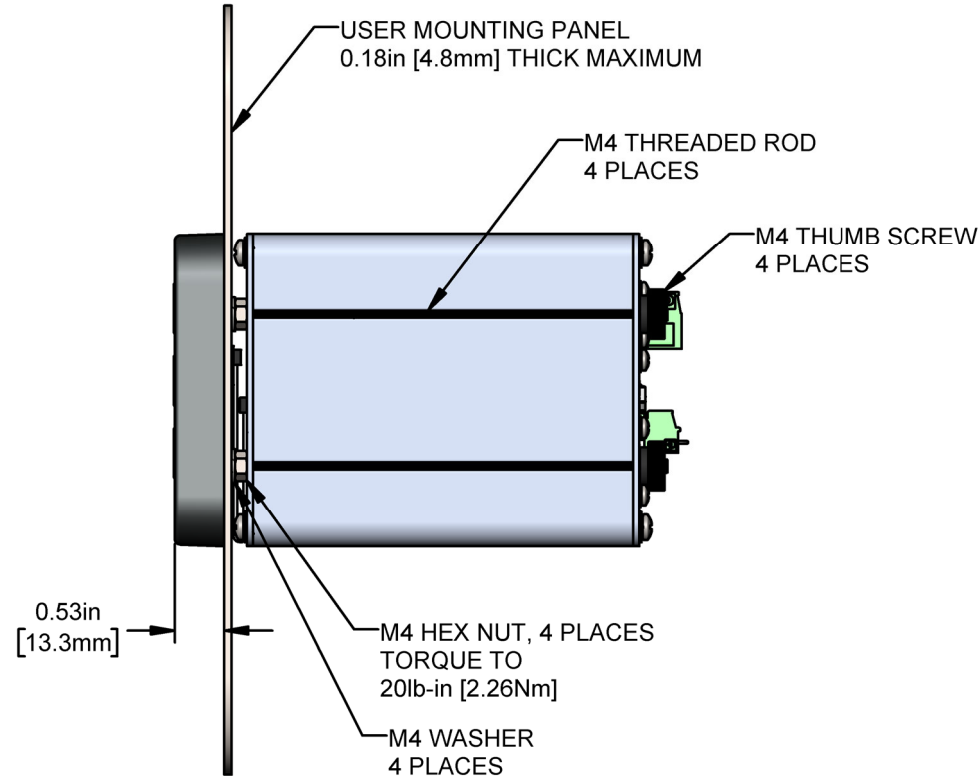
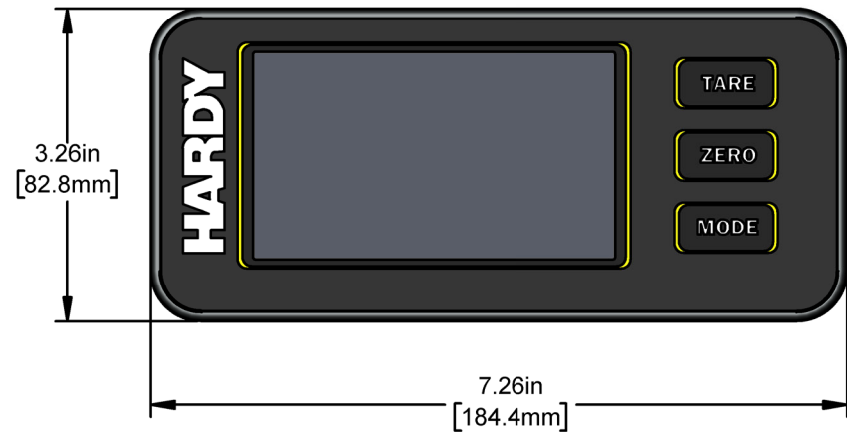

** IF THE DISPLAY IS TO BE MOUNTED REMOTELY FROM THE INSTRUMENT, USE M4 X 0.7 THREADED SCREW LENGTH OF 0.300 INCH [7.62mm] MAXIMUM PLUS THE MOUNTING PANEL THICKNESS

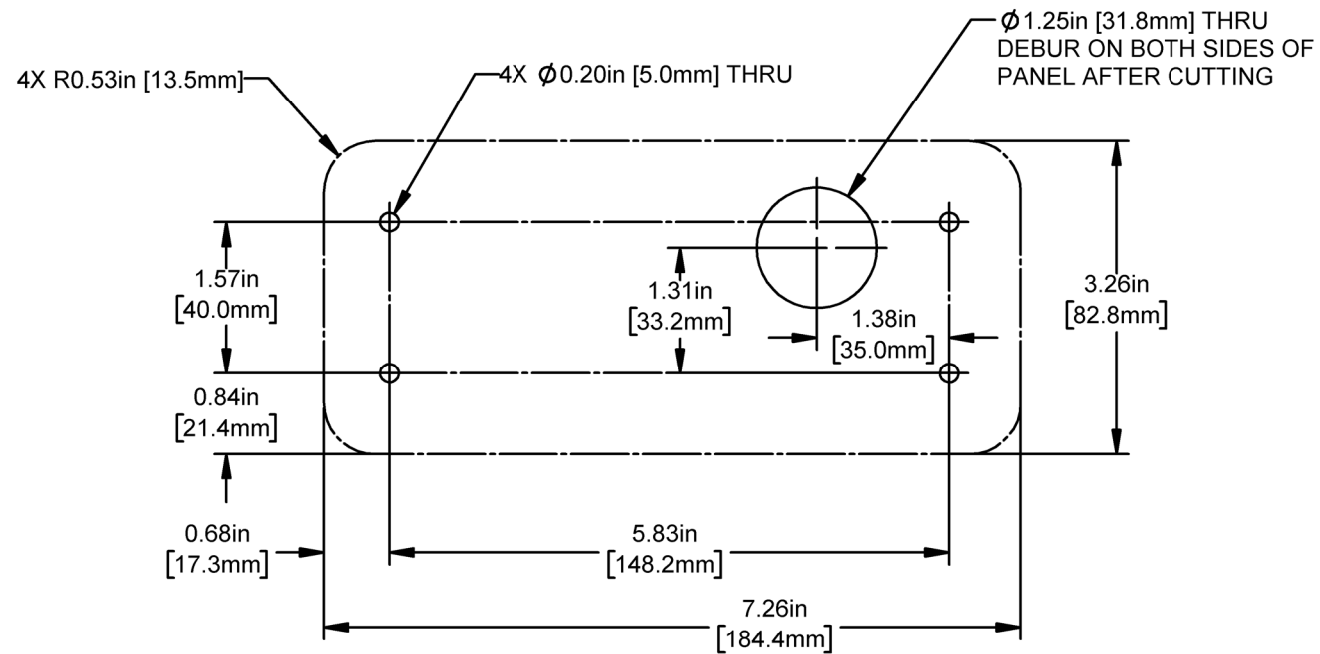

HI 6130 SERIES FRONT PANEL DISPLAY MOUNTING DIMENSIONS
(VIEWED FROM THE FRONT OF THE INSTRUMENT)

J9 CONNECTION CHART	
PIN NUMBER	SIGNAL NAME
1	V+
2	V+
3	CHASSIS GND
4	TXD-
5	TXD+
6	NO CONNECTION
7	RXD+
8	RXD-
9	GND
10	GND
RIBBON CABLE CONNECTOR	

FRONT PANEL DISPLAY TERMINATIONS

- NOTES:
1. INPUT VOLTAGE RATING: 12-24 VDC, 1.4 WATTS MAXIMUM.
 2. SEE USER'S GUIDE FOR ADDITIONAL INFORMATION ON FRONT PANEL DISPLAY TERMINATIONS. USER'S GUIDE IS LOCATED ON HARDY PROCESS SOLUTIONS WEB SITE.
 3. CONNECTOR J9 UTILIZES A 4.00 INCH [101.6mm] LONG 10 POSITION DISPLAY INTERFACE RIBBON CABLE THAT IS SHIPPED WITH THE HI 6850 SERIES INSTRUMENT WHEN OPTION "PM1" IS ORDERED.

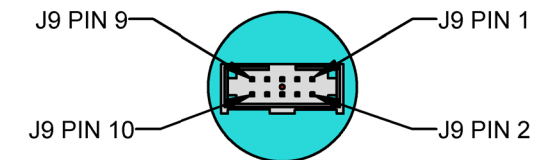

VIEW A
SCALE 2 : 1

HARDY PROCESS SOLUTIONS			
TITLE INSTALLATION/INTERCONNECTION DIAGRAM, HI 6850 SERIES			
SIZE	FSCM	DRAWING NO.	REV.
D	21316	0584-0113	A
FILE NAME: 0584-0113A1.SLDDRW		SCALE: NONE	SHEET 2 OF 6

HI 6850 SERIES INSTRUMENT WITH OPTION "PM2" FRONT PANEL DISPLAY

WHEN ORDERED, MOUNTING OPTION "PM2" OPTION KIT INCLUDES THE FOLLOWING COMPONENTS:

1. MODEL HI 6150 - 7.0 INCH TOUCH SCREEN LCD DISPLAY (SEALING GASKET INCLUDED); QTY 1.
2. 4.00 INCH [101.6mm] LONG 10 POSITION DISPLAY INTERFACE RIBBON CABLE; QTY 1.
3. M4 X 0.7, 126mm LONG THREADED RODS, QTY 4.
4. M4 FLAT WASHERS; QTY 4.
5. M4 X 0.7 HEX NUTS; QTY 4.
6. M4 X 0.7 THREADED THUMB NUTS; QTY 4.
7. DISPLAY MOUNTING HOLE DRILL TEMPLATE; QTY 1.
8. OPTION KIT "PM2" WILL BE SHIPPED SEPARATE WITH INSTRUMENT.
9. SEE HARDY PROCESS SOLUTIONS WEB SITE FOR FURTHER INFORMATION.

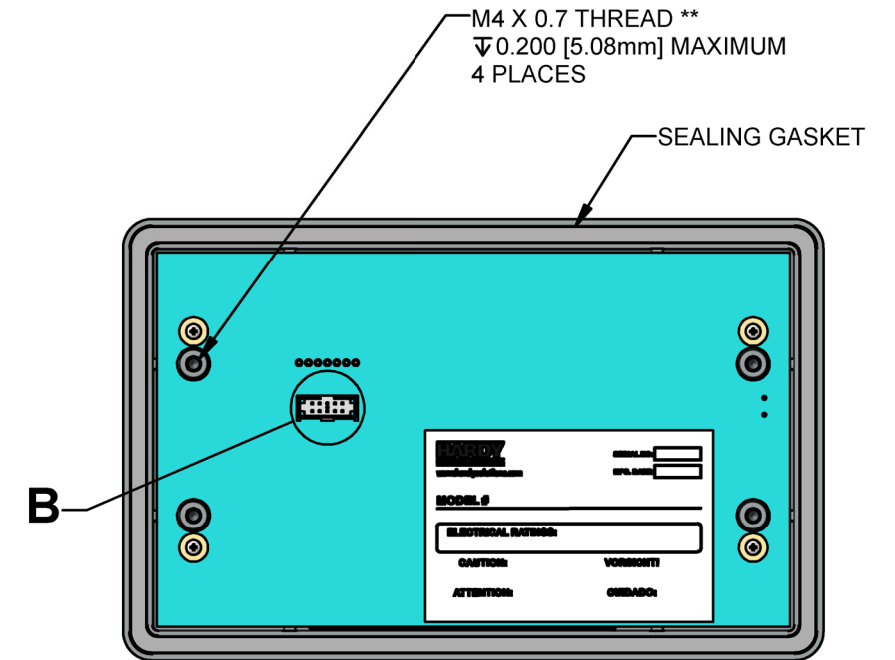
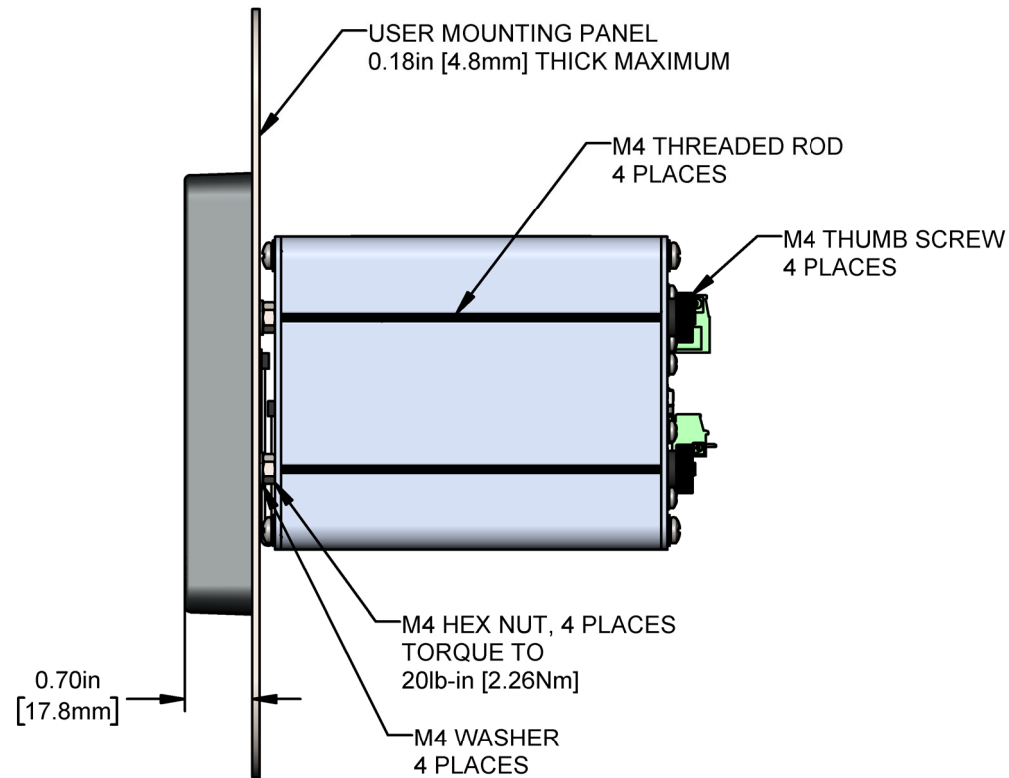
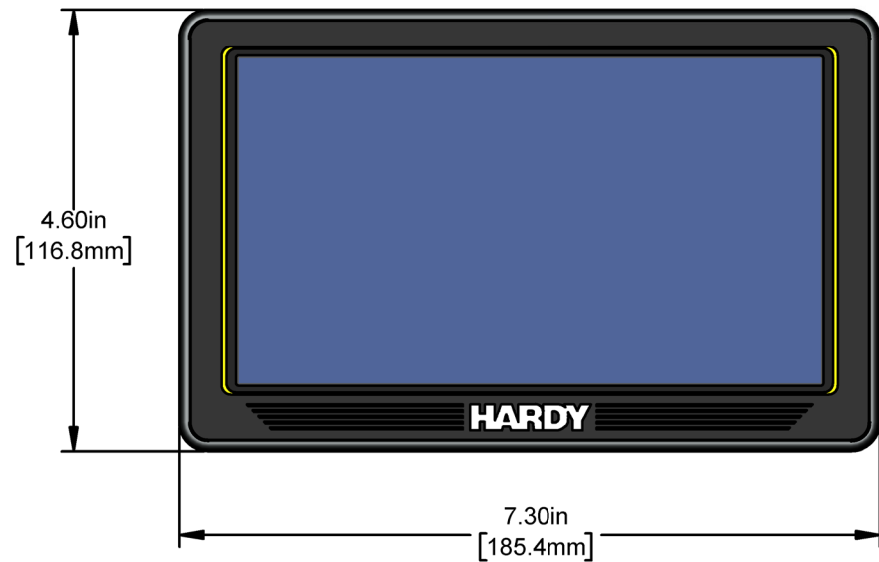

** IF THE DISPLAY IS TO BE MOUNTED REMOTELY FROM THE INSTRUMENT, USE M4 X 0.7 THREADED SCREW LENGTH OF 0.300 INCH [7.62mm] MAXIMUM PLUS THE MOUNTING PANEL THICKNESS

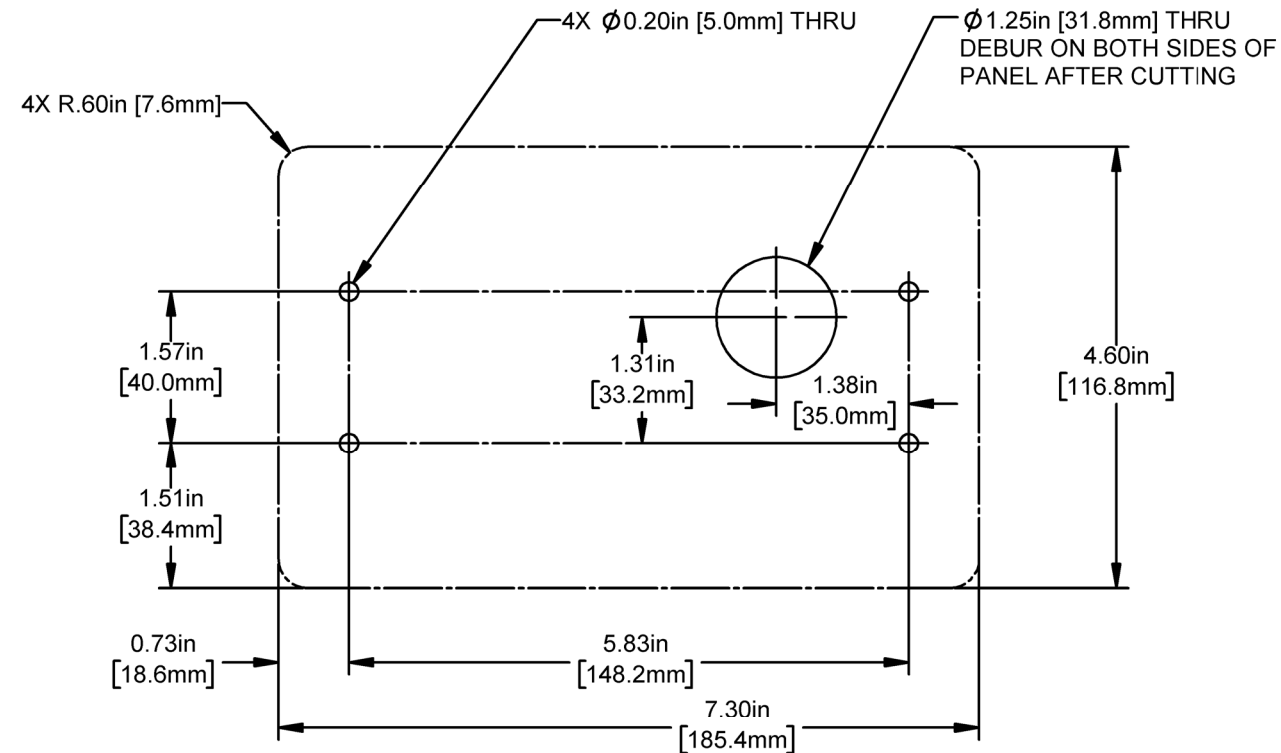

HI 6150 SERIES FRONT PANEL DISPLAY MOUNTING DIMENSIONS
(VIEWED FROM THE FRONT OF THE INSTRUMENT)

J9 CONNECTION CHART	
PIN NUMBER	SIGNAL NAME
1	V+
2	V+
3	CHASSIS GND
4	TXD-
5	TXD+
6	NO CONNECTION
7	RXD+
8	RXD-
9	GND
10	GND
RIBBON CABLE CONNECTOR	

FRONT PANEL DISPLAY TERMINATIONS

NOTES:

1. INPUT VOLTAGE RATING: 12-24 VDC, 2.4 WATTS MAXIMUM.
2. SEE USER'S GUIDE FOR ADDITIONAL INFORMATION ON FRONT PANEL DISPLAY TERMINATIONS. USER'S GUIDE IS LOCATED ON HARDY PROCESS SOLUTIONS WEB SITE.
3. CONNECTOR J9 UTILIZES A 4.00 INCH [101.6mm] LONG 10 POSITION DISPLAY INTERFACE RIBBON CABLE THAT IS SHIPPED WITH THE HI 6850 SERIES INSTRUMENT WHEN OPTION "PM2" IS ORDERED.

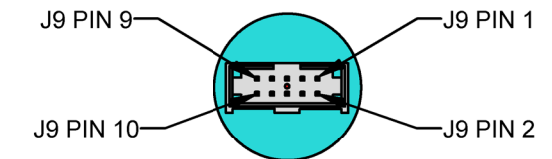

VIEW B
SCALE 2 : 1

HARDY PROCESS SOLUTIONS			
TITLE INSTALLATION/INTERCONNECTION DIAGRAM, HI 6850 SERIES			
SIZE	FSCM	DRAWING NO.	REV.
D	21316	0584-0113	A
FILE NAME: 0584-0113A1.SLDDRW		SCALE: NONE	SHEET 3 OF 6

HI 6850 SERIES INSTRUMENT USER INTERFACE PANEL CONNECTIONS

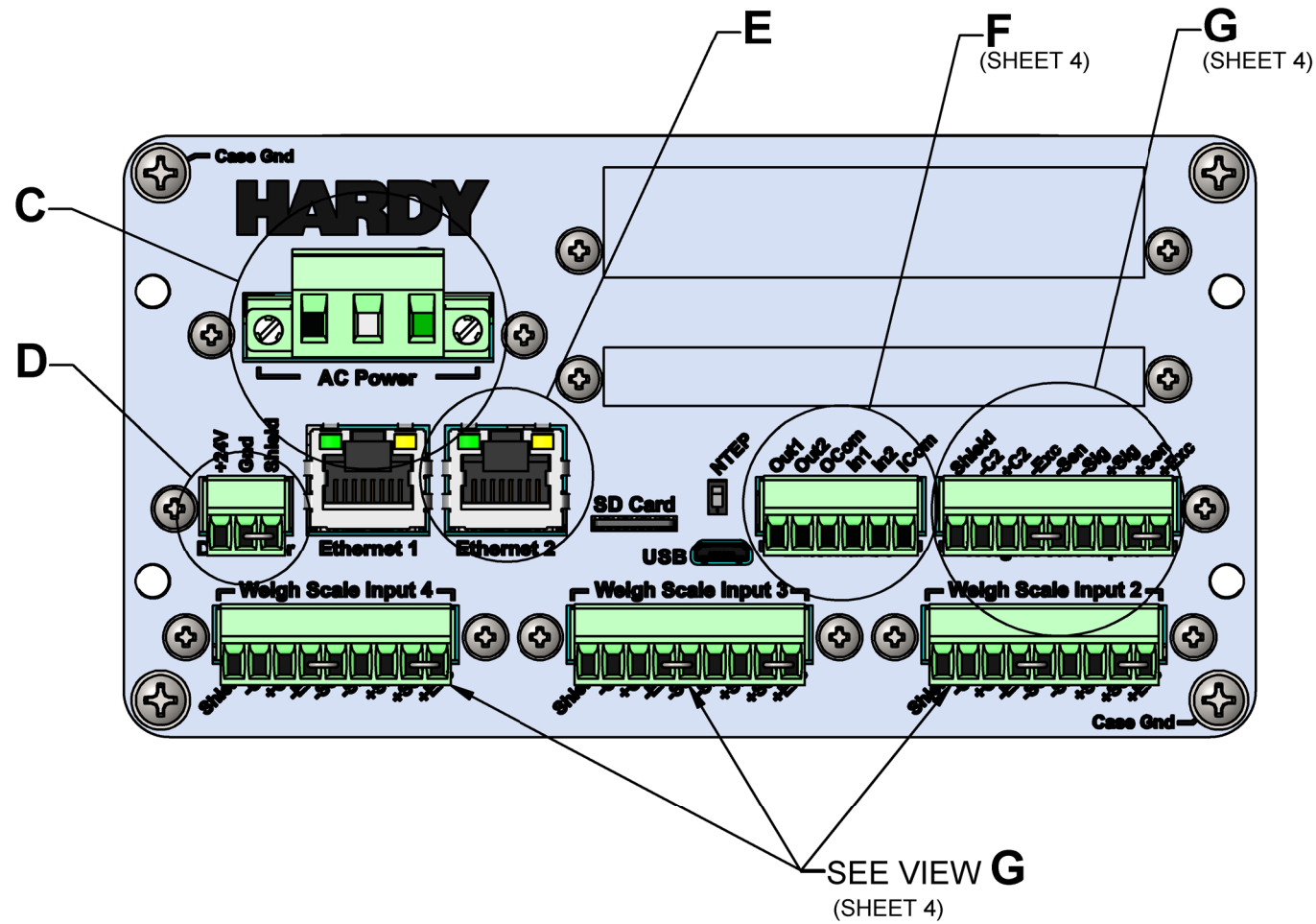

OPTION "AC" POWER INPUT TERMINATIONS

NOTES:

1. INPUT VOLTAGE RANGE: 100-240 VAC, 50/60 Hz, 0.75-0.50 AMP.
2. TERMINAL BLOCK WIRE SIZE RANGE: 12 AWG MAXIMUM / 24 AWG MINIMUM.
3. WIRE TEMPERATURE RATING TO BE 90° C.
4. WIRE TIGHTENING TORQUE: 5.0 LB-IN / 7.0 LB-IN [0.56 Nm / 0.79 Nm].
5. USE COPPER CONDUCTORS ONLY.

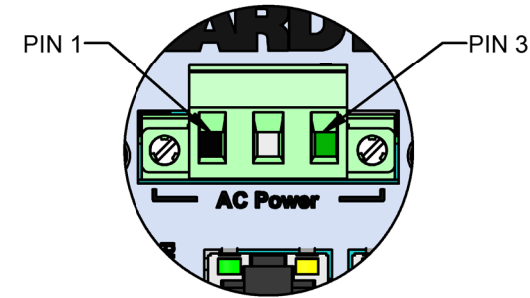

VIEW C
SCALE 2 : 1

CONNECTION CHART	
PIN NUMBER	SIGNAL NAME
1	LINE
2	NEUTRAL
3	EARTH

OPTION "DC" POWER INPUT TERMINATIONS

NOTES:

1. CLASS 2 INPUT VOLTAGE RANGE [24VDC NOMINAL]: 12-24 VDC, 3 WATTS NOMINAL.
2. TERMINAL BLOCK WIRE SIZE RANGE: 16 AWG MAXIMUM / 28 AWG MINIMUM.
3. WIRE TEMPERATURE RATING TO BE 90° C.
4. WIRE TIGHTENING TORQUE: 2.0 LB-IN / 2.2 LB-IN [0.23 Nm / 0.25 Nm].
5. USE COPPER CONDUCTORS ONLY.

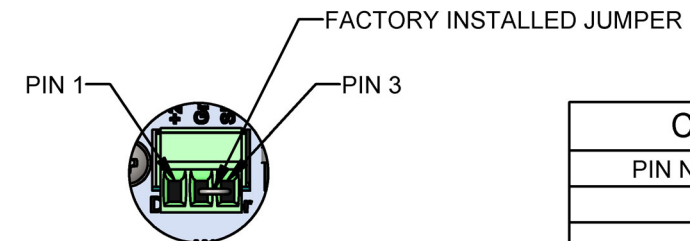

VIEW D
SCALE 2 : 1

CONNECTION CHART	
PIN NUMBER	SIGNAL NAME
1	+24V IN
2	GND
3	SHIELD

ETHERNET TERMINATIONS (BOTH PORTS)

NOTES:

1. SEE USER'S GUIDE FOR ADDITIONAL INFORMATION ON ETHERNET TERMINATIONS. USER'S GUIDE IS LOCATED ON HARDY PROCESS SOLUTIONS WEB SITE.
2. CONNECTOR TYPE: RJ-45, 8 PIN; QTY 2.

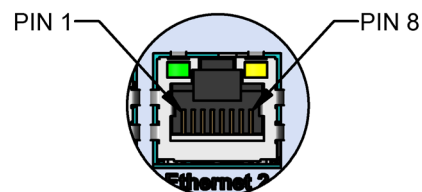

VIEW E
SCALE 2 : 1

CONNECTION CHART	
PIN NUMBER	SIGNAL NAME
1	TX+
2	TX-
3	V+
4	GND
5	GND
6	V+
7	RX+
8	RX-

HARDY
PROCESS SOLUTIONS

TITLE
INSTALLATION/INTERCONNECTION
DIAGRAM, HI 6850 SERIES

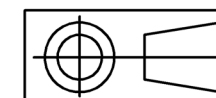

SIZE	FSCM	DRAWING NO.	REV.
D	21316	0584-0113	A
FILE NAME: 0584-0113A1.SLDDRW		SCALE: NONE	SHEET 4 OF 6

HI 6850 SERIES INSTRUMENT USER INTERFACE PANEL CONNECTIONS

DIGITAL I/O TERMINATIONS

NOTES:

1. SEE USER'S GUIDE FOR ADDITIONAL INFORMATION ON DIGITAL I/O TERMINATIONS. USER'S GUIDE IS LOCATED ON HARDY PROCESS SOLUTIONS WEB SITE.
2. DO NOT BUNDLE DIGITAL I/O WIRING WITH POWER WIRING, RELAY CABLE OR ANY OTHER HIGH ENERGY CABLES.
3. TERMINAL BLOCK WIRE SIZE RANGE: 16 AWG MAXIMUM / 28 AWG MINIMUM.
4. WIRE TEMPERATURE RATING TO BE 90° C.
5. WIRE TIGHTENING TORQUE: 2.0 LB-IN / 2.2 LB-IN [0.23 Nm / 0.25 Nm].
6. USE COPPER CONDUCTORS ONLY.

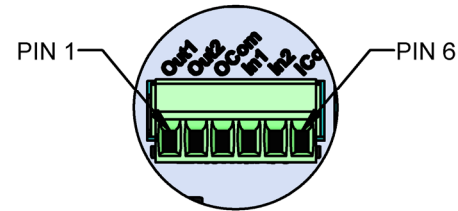

VIEW F
SCALE 2 : 1

CONNECTION CHART	
PIN NUMBER	SIGNAL NAME
1	OUT1
2	OUT2
3	OUT COMMON
4	IN1
5	IN2
6	IN COMMON

WEIGH SCALE INPUT TERMINATIONS TYPICAL FOR OPTIONS "NSA", "WS2", "WS3" AND "WS4"

NOTES:

1. SEE USER'S GUIDE FOR ADDITIONAL INFORMATION ON LOAD CELL CONNECTIONS. USER'S GUIDE IS LOCATED ON HARDY PROCESS SOLUTIONS WEB SITE.
2. IF CONDUIT IS USED, DO NOT RUN LOAD CELL CABLE PARALLEL TO, OR IN SAME CONDUIT WITH, POWER WIRING, RELAY CABLE OR OTHER HIGH ENERGY CABLES.
3. FACTORY INSTALLED JUMPERS TO REMAIN IN PLACE ONLY FOR FOUR WIRE NON C2 LOAD CELL CONNECTION. JUMPERS TO BE REMOVED FOR SIX WIRE NON C2 OR EIGHT WIRE C2 LOAD CELL CONNECTIONS. EXCITATION AND SENSE WIRES TO BE CONNECTED TOGETHER IN JUNCTION BOX.
4. TERMINAL BLOCK WIRE SIZE RANGE: 16 AWG MAXIMUM / 28 AWG MINIMUM.
5. WIRE TEMPERATURE RATING TO BE 90° C.
6. WIRE TIGHTENING TORQUE: 2.0 LB-IN / 2.2 LB-IN [0.23 Nm / 0.25 Nm].
7. USE COPPER CONDUCTORS ONLY.

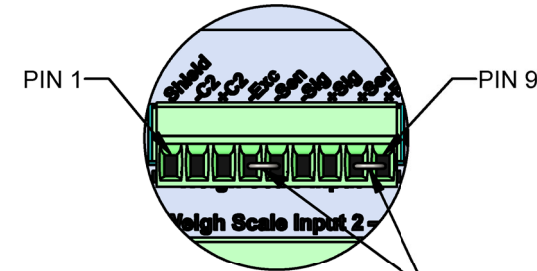

VIEW G
SCALE 2 : 1

CONNECTION CHART	
PIN NUMBER	SIGNAL NAME
1	SHIELD
2	-C2
3	+C2
4	-EXC
5	-SEN
6	-SIG
7	+SIG
8	+SEN
9	+EXC

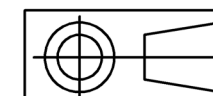

HARDY PROCESS SOLUTIONS			
TITLE INSTALLATION/INTERCONNECTION DIAGRAM, HI 6850 SERIES			
SIZE	FSCM	DRAWING NO.	REV.
D	21316	0584-0113	A
FILE NAME: 0584-0113A1.SLDDRW		SCALE: NONE	SHEET 5 OF 6

HI 6850 SERIES INSTRUMENT USER INTERFACE PANEL CONNECTIONS

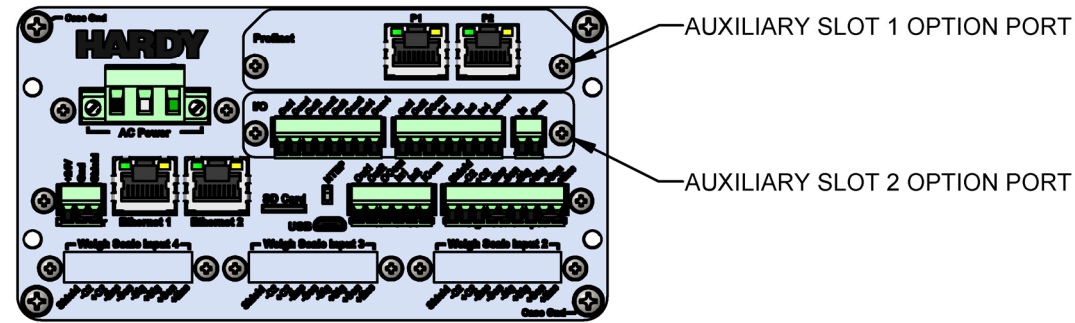

OPTION "GPRC" GENERAL PURPOSE RELAY TERMINATIONS

- NOTES:
- SEE USER'S GUIDE FOR ADDITIONAL INFORMATION ON RELAY TERMINATIONS. USER'S GUIDE IS LOCATED ON HARDY PROCESS SOLUTIONS WEB SITE.
 - DC RELAY RATINGS: 30 VDC @ 1.0 AMP.
 - TERMINAL BLOCK WIRE SIZE RANGE: 16 AWG MAXIMUM / 28 AWG MINIMUM.
 - WIRE TEMPERATURE RATING TO BE 90° C.
 - WIRE TIGHTENING TORQUE: 2.0 LB-IN / 2.2 LB-IN [0.23 Nm / 0.25 Nm].
 - USE COPPER CONDUCTORS ONLY.
 - WHEN ORDERED, THIS OPTION CAN BE INSTALLED IN EITHER ONE OR BOTH OF THE AUXILIARY SLOT OPTION PORTS.

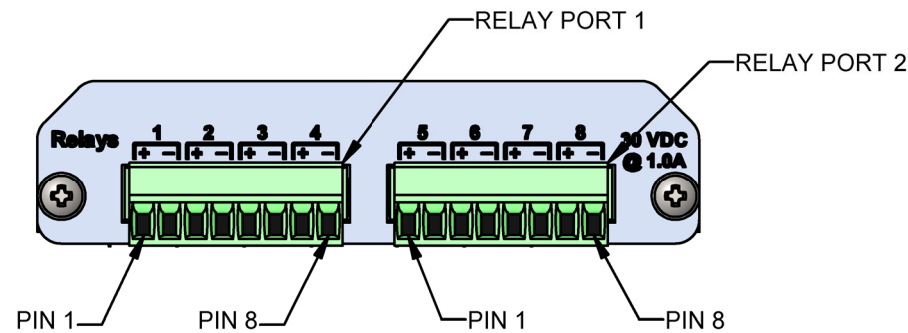

PIN NUMBER	SIGNAL NAME
1	OUT 1 +
2	OUT 1 -
3	OUT 2 +
4	OUT 2 -
5	OUT 3 +
6	OUT 3 -
7	OUT 4 +
8	OUT 4 -

PIN NUMBER	SIGNAL NAME
1	OUT 5 +
2	OUT 5 -
3	OUT 6 +
4	OUT 6 -
5	OUT 7 +
6	OUT 7 -
7	OUT 8 +
8	OUT 8 -

OPTION "GPIO" GENERAL PURPOSE INPUT/OUTPUT TERMINATIONS

- NOTES:
- SEE USER'S GUIDE FOR ADDITIONAL INFORMATION ON ANALOG AND DIGITAL I/O TERMINATIONS. USER'S GUIDE IS LOCATED ON HARDY PROCESS SOLUTIONS WEB SITE.
 - DO NOT BUNDLE ANALOG AND DIGITAL I/O WIRING WITH POWER WIRING, RELAY CABLE OR ANY OTHER HIGH ENERGY CABLES.
 - TERMINAL BLOCK WIRE SIZE RANGE: 16 AWG MAXIMUM / 28 AWG MINIMUM.
 - WIRE TEMPERATURE RATING TO BE 90° C.
 - WIRE TIGHTENING TORQUE: 2.0 LB-IN / 2.2 LB-IN [0.23 Nm / 0.25 Nm].
 - USE COPPER CONDUCTORS ONLY.
 - WHEN ORDERED, THIS OPTION CAN BE INSTALLED IN EITHER ONE OR BOTH OF THE AUXILIARY SLOT OPTION PORTS.

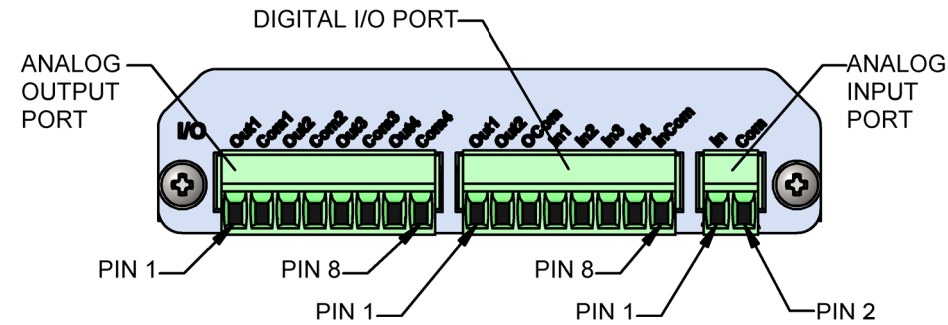

PIN NUMBER	SIGNAL NAME
1	ANALOG OUT 1
2	ANALOG OUT 1 COMMON
3	ANALOG OUT 2
4	ANALOG OUT 2 COMMON
5	ANALOG OUT 3
6	ANALOG OUT 3 COMMON
7	ANALOG OUT 4
8	ANALOG OUT 4 COMMON

PIN NUMBER	SIGNAL NAME
1	4-20MA INPUT
2	COMMON

PIN NUMBER	SIGNAL NAME
1	DIGITAL OUT 1
2	DIGITAL OUT 2
3	DIGITAL OUT COMMON
4	DIGITAL IN 1
5	DIGITAL IN 2
6	DIGITAL IN 3
7	DIGITAL IN 4
8	DIGITAL IN COMMON

OPTION "PFNC" - PROFINET COMMUNICATIONS TERMINATIONS

- NOTES:
- SEE USER'S GUIDE FOR ADDITIONAL INFORMATION ON PROFINET TERMINATIONS. USER'S GUIDE IS LOCATED ON HARDY PROCESS SOLUTIONS WEB SITE.
 - CONNECTOR TYPE: RJ-45, 8 PIN; QTY 2.
 - WHEN ORDERED, THIS OPTION CAN ONLY BE INSTALLED IN THE AUXILIARY SLOT 1 OPTION PORT.

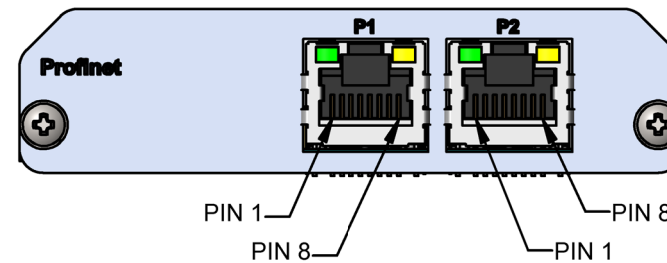

PIN NUMBER	SIGNAL NAME
1	TX+
2	TX-
3	V+
4	GND
5	GND
6	V+
7	RX+
8	RX-

HARDY
PROCESS SOLUTIONS

TITLE
INSTALLATION/INTERCONNECTION
DIAGRAM, HI 6850 SERIES

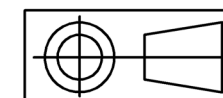

SIZE	FSCM	DRAWING NO.	REV.
D	21316	0584-0113	A
FILE NAME: 0584-0113A1.SLDDRW		SCALE: NONE	SHEET 6 OF 6